

Retaining Magnets

Neodymium-Iron-Boron (NdFeB), with Internal Thread, with Rubber Jacket

SPECIFICATION

Types

- Type **A**: With 1 internal thread
- Type **B**: With 2 internal threads

Magnet

NdFeB
Neodymium, iron, boron
Operating temperature up to 80 °C

Steel part

Zinc plated

Sheathing

Thermoplastic polyurethane (TPE)

- Black **SW**
- White **WS**
- Hardness ≈ 80 Shore A



INFORMATION

The retaining magnets GN 57.1 with rubber jacket form a system together with the steel part that shields and strengthens the magnet, optimally concentrating the magnetic flux on the rubberized magnetic surface.

The rubber protects sensitive surfaces from being damaged by the magnet and also delivers a high friction coefficient, resulting in high lateral displacement forces.

ACCESSORY

- GN 70 Holding Disks (see page 2051)
- GN 70.1 Adhesive Disks (see page 2051)

ON REQUEST

- Other colors
- Other Shore hardnesses

TECHNICAL INFORMATION

- More Information on Retaining Magnets (see page 2022)
- Plastic Characteristics (see page A2)

Type A

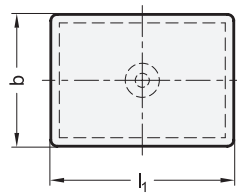

Type B

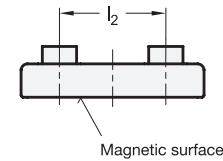
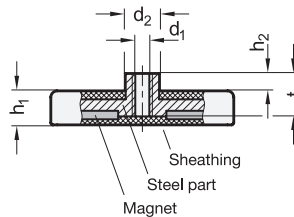
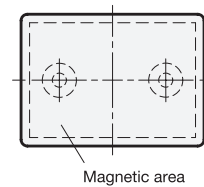

* Complete with

SW Black
WS White

GN 57.1-A

Description	b	l ₁	d ₁	d ₂	h ₁	h ₂	l ₂	t	Nominal magnetic forces in N	⚖
GN 57.1-22.5-35-M4-A-*	22.5	35	M 4	8	6	5	17	6	93	22
GN 57.1-22.5-55-M4-A-*	22.5	55	M 4	8	6	5	30	6	140	33
GN 57.1-22.5-75-M4-A-*	22.5	75	M 4	8	6	5	50	6	205	46
GN 57.1-31-43-M4-A-*	31	43	M 4	10	6	1	25	4.5	105	55
GN 57.1-45-59-M5-A-*	45	59	M 5	10	8.5	6.2	27	9	240	85
GN 57.1-45-74-M5-A-*	45	74	M 5	10	8.5	6.2	36	9	360	108
GN 57.1-45-110-M6-A-*	45	110	M 6	10	8.5	6.2	68	9	530	156

Weight SW

GN 57.1-B

Description	b	l ₁	d ₁	d ₂	h ₁	h ₂	l ₂	t	Nominal magnetic forces in N	⚖
GN 57.1-22.5-35-M4-B-*	22.5	35	M 4	8	6	5	17	6	93	25
GN 57.1-22.5-55-M4-B-*	22.5	55	M 4	8	6	5	30	6	140	35
GN 57.1-22.5-75-M4-B-*	22.5	75	M 4	8	6	5	50	6	205	50
GN 57.1-31-43-M4-B-*	31	43	M 4	10	6	1	25	4.5	146	60
GN 57.1-45-59-M5-B-*	45	59	M 5	10	8.5	6.2	27	9	240	90
GN 57.1-45-74-M5-B-*	45	74	M 5	10	8.5	6.2	36	9	360	113
GN 57.1-45-110-M6-B-*	45	110	M 6	10	8.5	6.2	68	9	530	161

Weight SW